

86030 TIRE SWING (WOOD COLUMNS) 86031 TIRE SWING (METAL COLUMNS)

Parts List			
DESCRIPTION	86030	86031	PART NUMBER
TOP RAIL	1	1	405368
PLASTIC BLACK TIRE	1	1	300196
11' COLUMN, G-LAM	4	0	Z011
11' COLUMN, METAL	0	4	401850
TIRE RING FRAME	1	1	304005
COATED CHAIN W/ HOOK	3	3	303659
HARDWARE COMPLETE	1	0	405369
HARDWARE COMPLETE	0	1	405370
END CAP	4	4	G010
12MM DO-NUT CAP	8	8	G036
12MM DO-NUT BASE	8	8	G034
SWIVEL ASSEMBLY	1	1	159194
3/8" LOCK NUT	6	6	804353
U-BOLT	3	3	803441
BRACKET	3	3	303833
COLUMN END FITTING - WOOD	4	0	Z600
COLUMN END FITTING - METAL	0	4	M600
EAGLE FASTENER	8	0	G000
THREADED INSERT	0	8	M000
#10 x 2" WOOD SCREW	12	0	815507
#10 x 1/2" SHEET METAL SCREW	0	12	810062
HOLE PLUG	160	0	G005G
1/2" FLATWASHER (7/8" O.D.)	8	8	817465
1/2" x 2 1/2" HEX HEAD BOLT	8	0	801225
1/2" X 1 3/4" HEX HEAD BOLT	0	8	801206
10" PIPE	4	0	401991
#3 REBAR, 20" LG.	0	4	655020
PIN-IN HEX BIT	1	1	812644
1/2" x 1 1/4" B.H.C.S.	2	2	811062
1/2" LOCKWASHER	2	2	817342
1/2" HEX NUT	2	2	804055

Unless Otherwise Specified, All Units of Measure are Each

Items listed below Hardware Complete line are included with Hardware Complete Number

Warning: During Installation, Hardware And Small Parts Are Choking Hazards For Young Children. Store Unused Parts Appropriately Until Assembly Is Completed. Once Assembly Is Completed, Remove Any Unused Parts From The Play Environment And Dispose/Save Them In A Secure Location. Any bolt end protruding more than two full threads beyond the face of the nut causes risk of clothing entanglement.

Promptly cut-off flush, file smooth, and treat to prevent corrosion.

Note: Peen Tee-Nuts and Flatwashers to match radius of pipe after assembly is complete.

Note: Loctite (supplied by others) should be used on any non-patch hardware.

86030 TIRE SWING (WOOD COLUMNS) 86031 TIRE SWING (METAL COLUMNS)

SPECIFICATIONS:

Tire Swing: Shall be fabricated from Linear Low Density Polyethylene with a welded reinforcing ring frame which will be fabricated from 1.029" o.d.(.072" wall) galvanized pipe which shall receive a polyester powder coat finish.

Toprail: shall be fabricated from 5" O.D. Galvanized tubing welded to 3/16" thick HR steel plate and formed bracket. Shall receive polyester powder coat finish.

Chain: Is #80 chain, 44 11/16" Lg. assembled together with "S" Hook and PVC coated.

Wood Column: is 6" diameter laminated treated lumber with factory drilled holes

Metal Column: is 6" diameter 12 GA galvanized tubing with a polyester powder coat finish.

INSTALLATION INSTRUCTIONS

NOTE: THIS INSTALLATION BOOKLET SHOULD BE KEPT IN CUSTOMER'S FILE FOR FUTURE REFERENCE.

NOTE: Do not overtighten bolts. To overtighten may cause buckling or dimpling of some parts.

NOTE: Read installation instructions thoroughly before starting assembly. Pour concrete only after final assembly is complete. Bracing material may be required during assembly.

NOTE: Do not tighten any nuts, bolts, rods, etc. until the unit is completely assembled.

NOTE: Due to extremes in weather and soil conditions, hole sizes may have to be increased to meet local conditions.

STEP 1: Dig holes according to the Plan and Elevation view. Place a brick or equivalent at the bottom of the hole to provide a solid foundation. Allow for this in hole depth.

STEP 2: Attach Column End Fitting and End Cap on top of each Column as shown in Detail 031 for Metal Columns or Detail 032 for Wood Columns.

STEP 3: Place Column into each dug hole. Place rebar or pipe in bottom hole of column. Attach Toprail to each Column as shown in Detail 219 for Metal Columns or Detail 217 for Wood Columns.

STEP 4: Assemble Tire, Tire Ring frame, and chains using Detail 357. Attach Swivel Assembly to the Toprail as shown in Detail 358.

NOTE: FULLY CRIMP SHUT ALL "S" HOOKS THAT ATTACH CHAIN TO THE SWIVEL ASSEMBLY.

STEP 5: Fill holes with concrete. Plumb and brace assembly. Allow a minimum of 48 hours for concrete to harden before use.

NOTE: Loctite (supplied by others) should be used on all threaded hardware.

MAINTENANCE PROCEDURE:

Periodically check hardware for tightness, and tighten as necessary. Always check all parts for breakage or wear, and immediately put equipment out of service until any faulty parts found are repaired or replaced. Also Check all metal parts for rust, paint loss and touch-up if necessary with paint. Check for welded areas and verify integrity. Check periodically resilient surfacing for appropriate depth and remove extraneous materials that could cause injury, infection, or disease. Maintain detailed installation, inspection, maintenance, and repair records for each public-use playground equipment.

86030 TIRE SWING (WOOD COLUMNS) 86031 TIRE SWING (METAL COLUMNS)

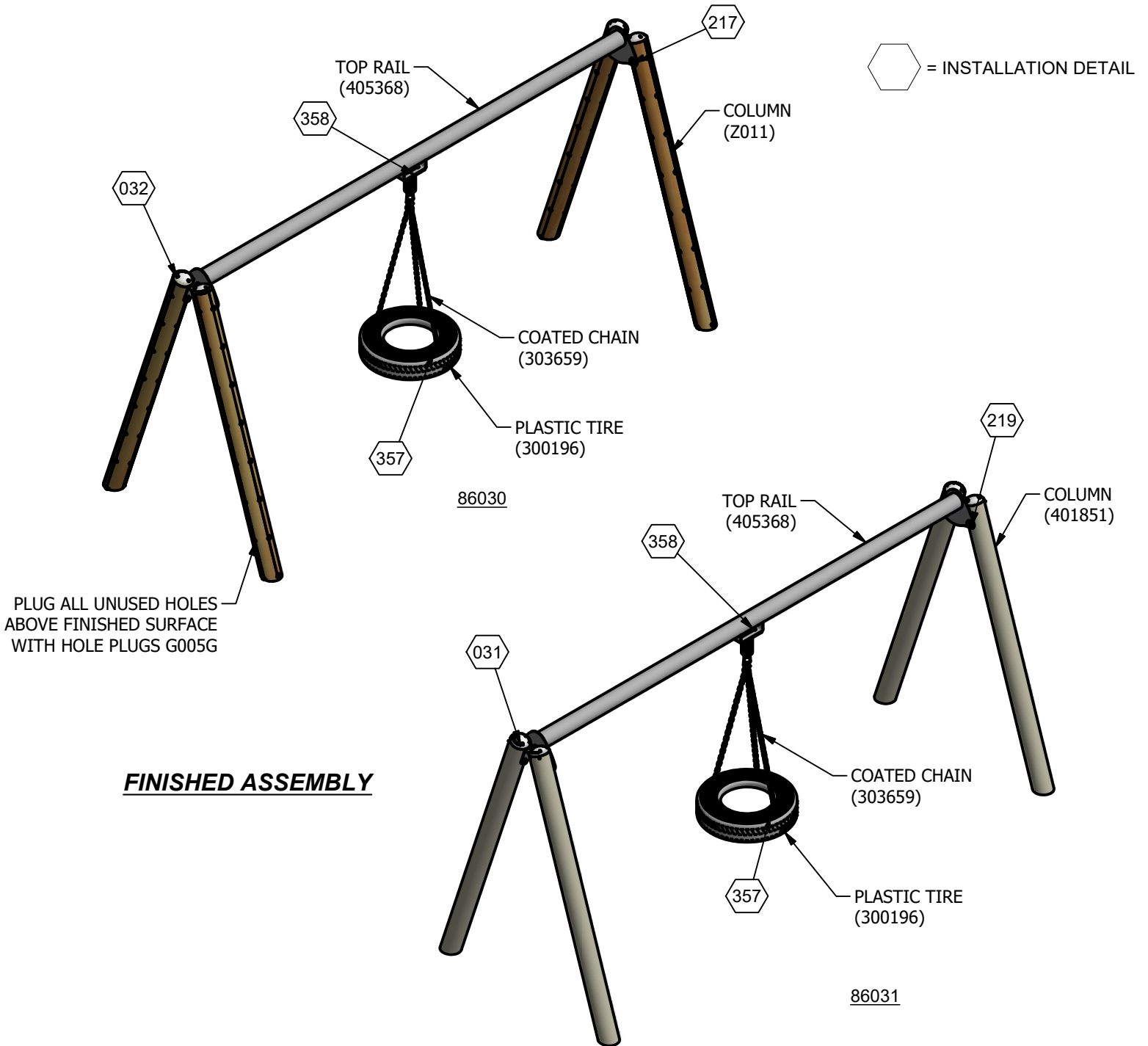

86030 TIRE SWING (WOOD COLUMNS) 86031 TIRE SWING (METAL COLUMNS)

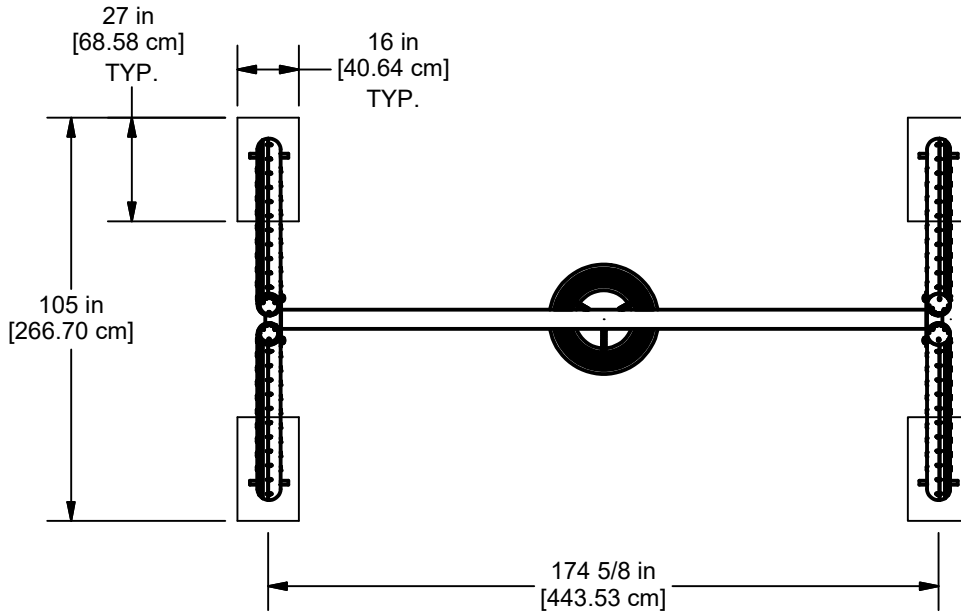

PLAN VIEW

CONCRETE REQUIRED

1.04 CUBIC YARDS
.80 [CUBIC METERS]

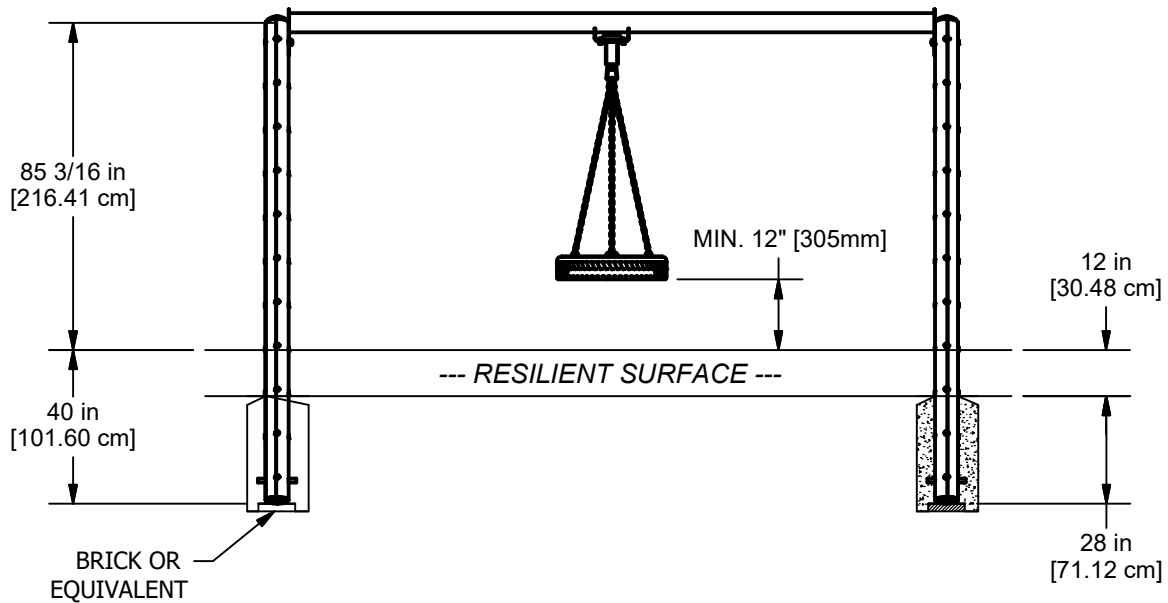

ELEVATION VIEW

86030 TIRE SWING (WOOD COLUMNS) 86031 TIRE SWING (METAL COLUMNS)

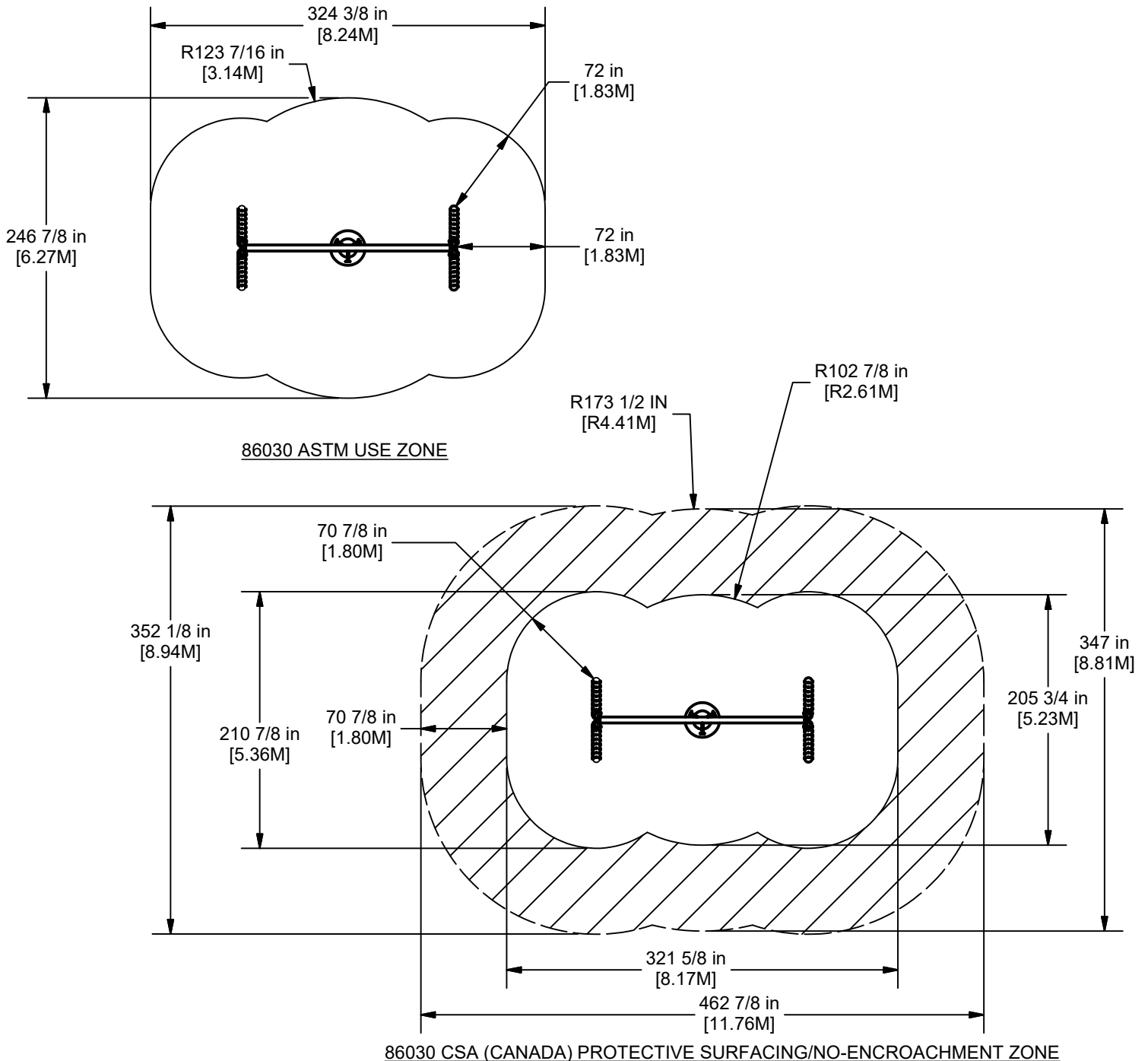

NOTES:

- OWNER/OPERATOR SHALL INSTALL AND MAINTAIN PROTECTIVE SURFACING WITHIN THE USE ZONE (U.S.) OR PROTECTIVE SURFACING ZONE (CANADA) OF ALL PLAY EQUIPMENT TO COMPLY WITH ASTM F-1292 AND ASTM F-1487 (U.S.) OR CAN/CSA-Z-314 (CANADA).
- SOLID OUTSIDE BORDER REPRESENTS MINIMUM REQUIRED ASTM USE ZONE AND CSA PROTECTIVE SURFACING ZONE FOR SWING FRAME SHOWN.
- DASHED LINES REPRESENT CSA *NO ENCROACHMENT* ZONE (CANADA ONLY).

Issued/Revised: 11/3/17

86030 TIRE SWING (WOOD COLUMNS) 86031 TIRE SWING (METAL COLUMNS)

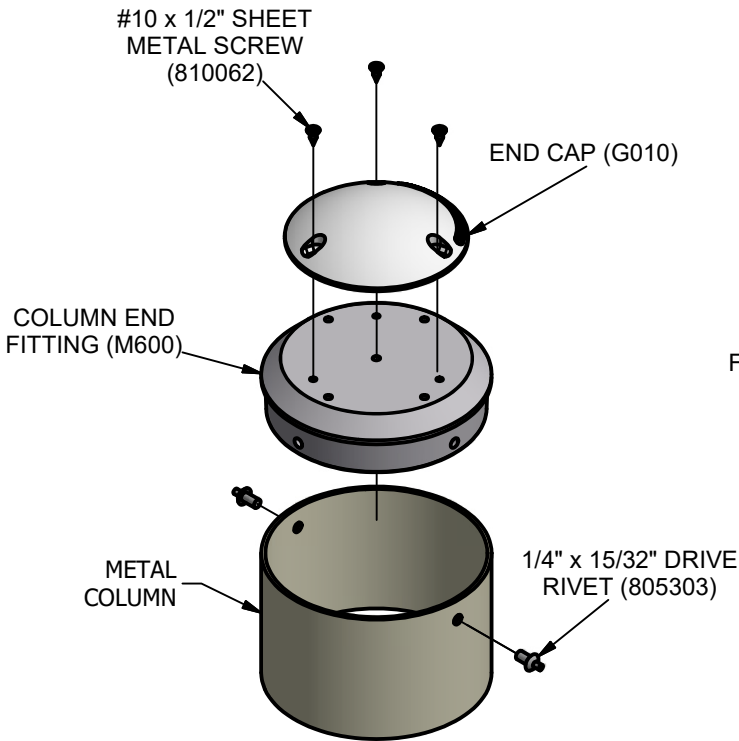

031

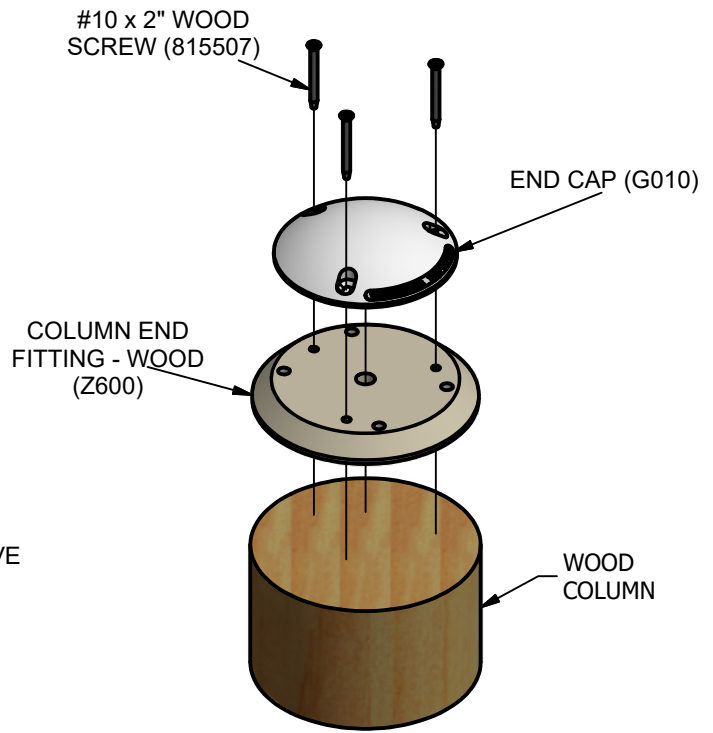

032

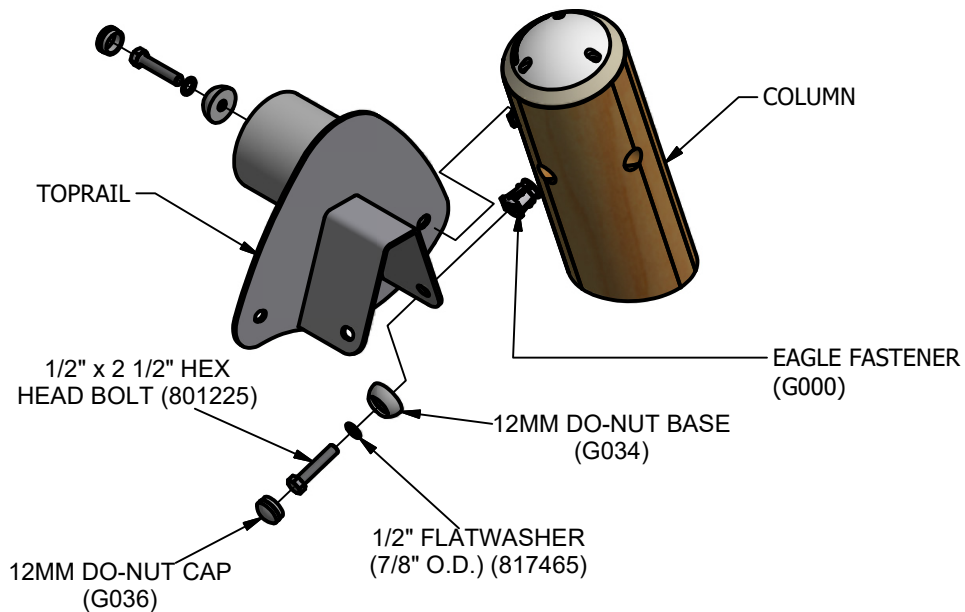

217

86030 TIRE SWING (WOOD COLUMNS) 86031 TIRE SWING (METAL COLUMNS)

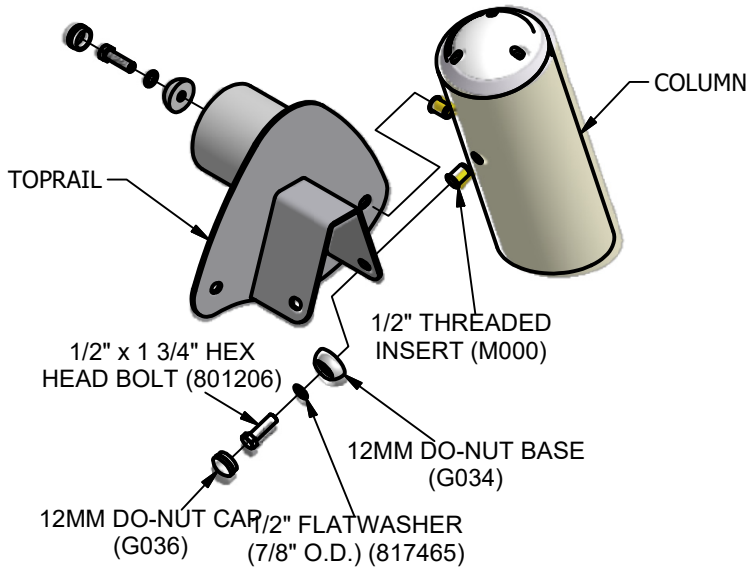

219

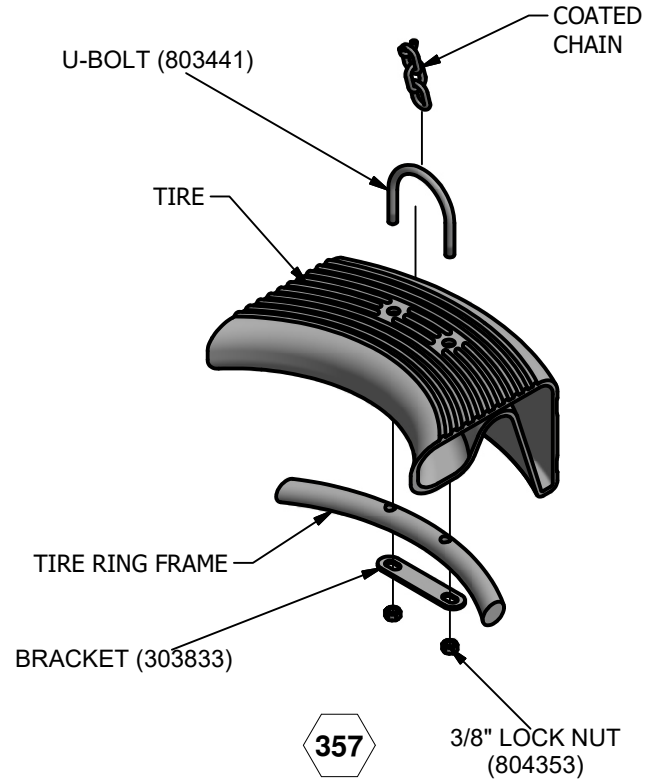

357

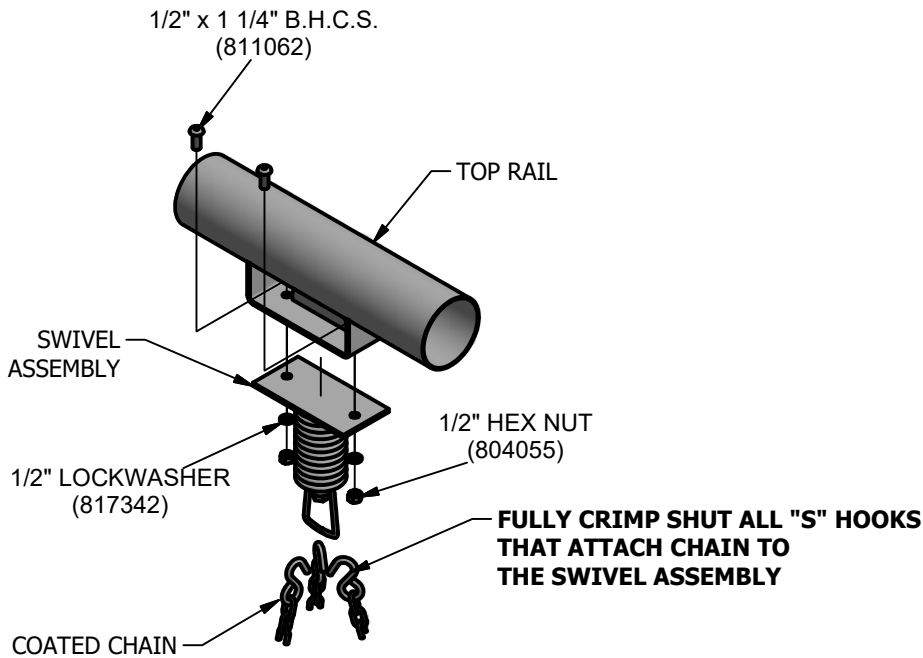

358