

UP267 STRENGTH ZONE

| Parts List | | |
|-----------------------------------|-----|-------------|
| DESCRIPTION | QTY | PART NUMBER |
| UPRIGHT | 4 | 15CHUN |
| STRENGTH ZONE BASE | 2 | 408033 |
| STRENGTH ZONE HAND RAIL | 4 | 408039 |
| STRENGTH ZONE LADDER | 1 | 408042 |
| STRENGTH ZONE PLATFORM | 2 | 408043 |
| HARDWARE COMPLETE | 1 | 408045 |
| 3/8" x 1" P.B.H.C.S. w/PATCH | 4 | 812050 |
| 3/8" x 1 1/4" P.B.H.C.S. w/PATCH | 24 | 812051 |
| 3/8" x 2" P.B.H.C.S. w/PATCH | 22 | 812055 |
| 3/8" LOCK WASHER | 50 | 817334 |
| 3/8" FLAT WASHER | 24 | 817410 |
| 3/8" BARREL NUT | 26 | 804804 |
| 1/2" ANCHOR ROD | 4 | 135038 |
| STRENGTH ZONE USAGE WARNING LABEL | 1 | 408044 |

Unless Otherwise Specified, All Units of Measure are Each

Items listed below Hardware Complete line are included with Hardware Complete Number

Warning: During Installation, Hardware And Small Parts Are Choking Hazards For Young Children. Store Unused Parts Appropriately Until Assembly Is Completed. Once Assembly Is Completed, Remove Any Unused Parts From The Play Environment And Dispose/Save Them In A Secure Location. Any bolt end protruding more than two full threads beyond the face of the nut causes risk of clothing entanglement.

Promptly cut-off flush, file smooth, and treat to prevent corrosion.

Note: Peen Tee-Nuts and Flatwashers to match radius of pipe after assembly is complete.

Note: Loctite (supplied by others) should be used on any non-patch hardware.

INSTALLATION INSTRUCTIONS:

1. Determine where to place the Strength Zone. Refer to order Top View.
2. Dig footing holes. Refer to Plan Views.
3. Attach the Strength Zone Bases to the Upright. See Detail 1267. Refer to Finished Assembly view.
4. Attach the Strength Zone Platform to the Strength Zone Bases. See Detail 353.
5. Attach the Strength Zone Hand Rails to the Strength Zone Bases and Upright. See Details 430 and 1267.
6. Attach Strength Zone Ladder to the Upright. See Detail 1267.
7. Attach the Strength Zone Usage Warning Label to the Upright. Refer to Finished Assembly view for placement.
8. Place the assembled Strength Zone into footing holes.
9. When the Strength Zone is plumb and level, tighten all fasteners and pour concrete footings within 4" to the top and taper away from supports to allow drainage. Allow to cure at least 48 hours before use.

MAINTENANCE PROCEDURE:

Periodically check hardware for tightness, and tighten as necessary. Always check all parts for breakage or wear, and immediately put equipment out of service until any faulty parts found are repaired or replaced. Also check all metal parts for rust, paint loss and touch-up if necessary with paint. Check welded areas and verify integrity. Check periodically resilient surfacing for appropriate depth and remove extraneous materials that could cause injury, infection, or disease. Maintain detailed installation, inspection, maintenance, and repair records for each public-use playground equipment.

UP267 STRENGTH ZONE

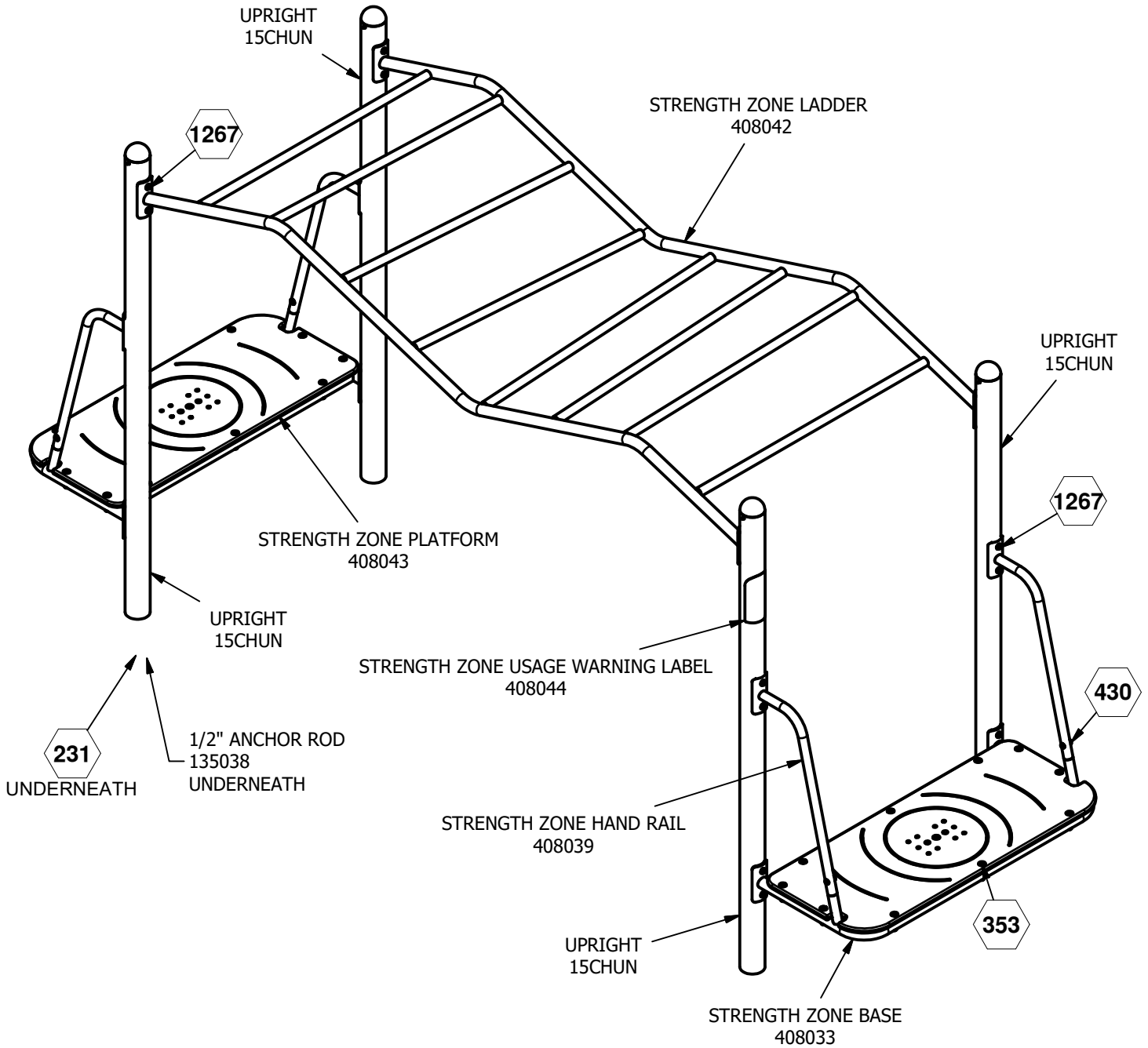

= INSTALLATION DETAIL

Issued/Revised: 4/25/2024

FINISHED ASSEMBLY

ultra site
 A PLAYCORE Company

UP267 STRENGTH ZONE

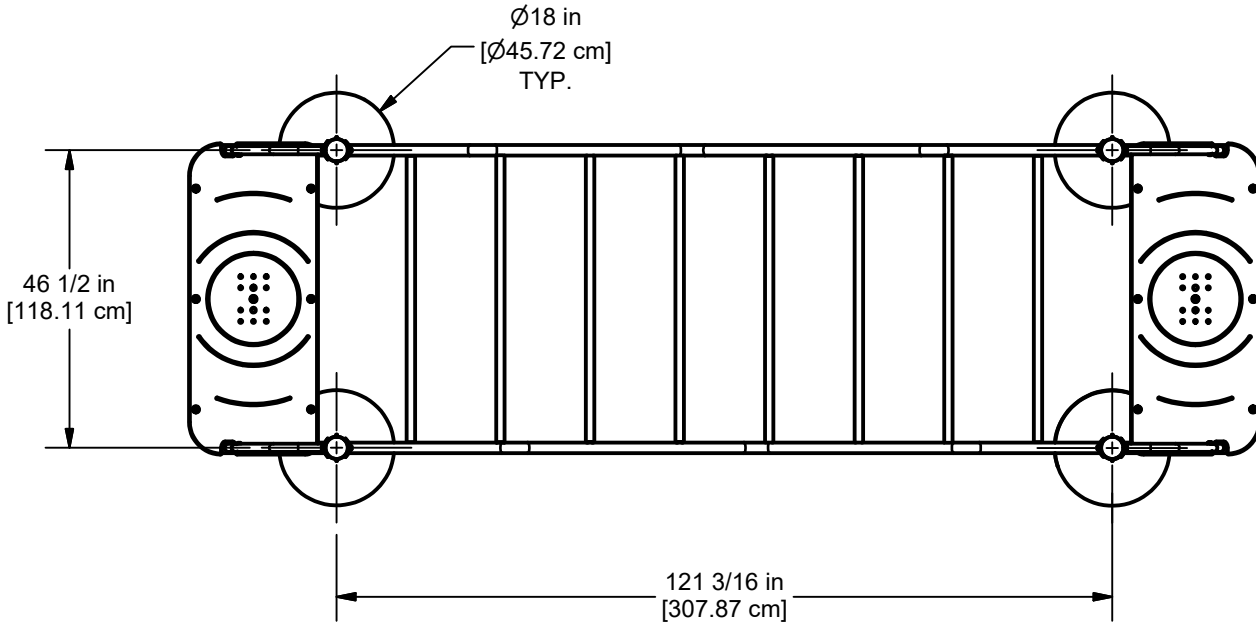

PLAN VIEW

CONCRETE REQUIRED
 0.436 CUBIC YARDS
 0.332 [CUBIC METERS]

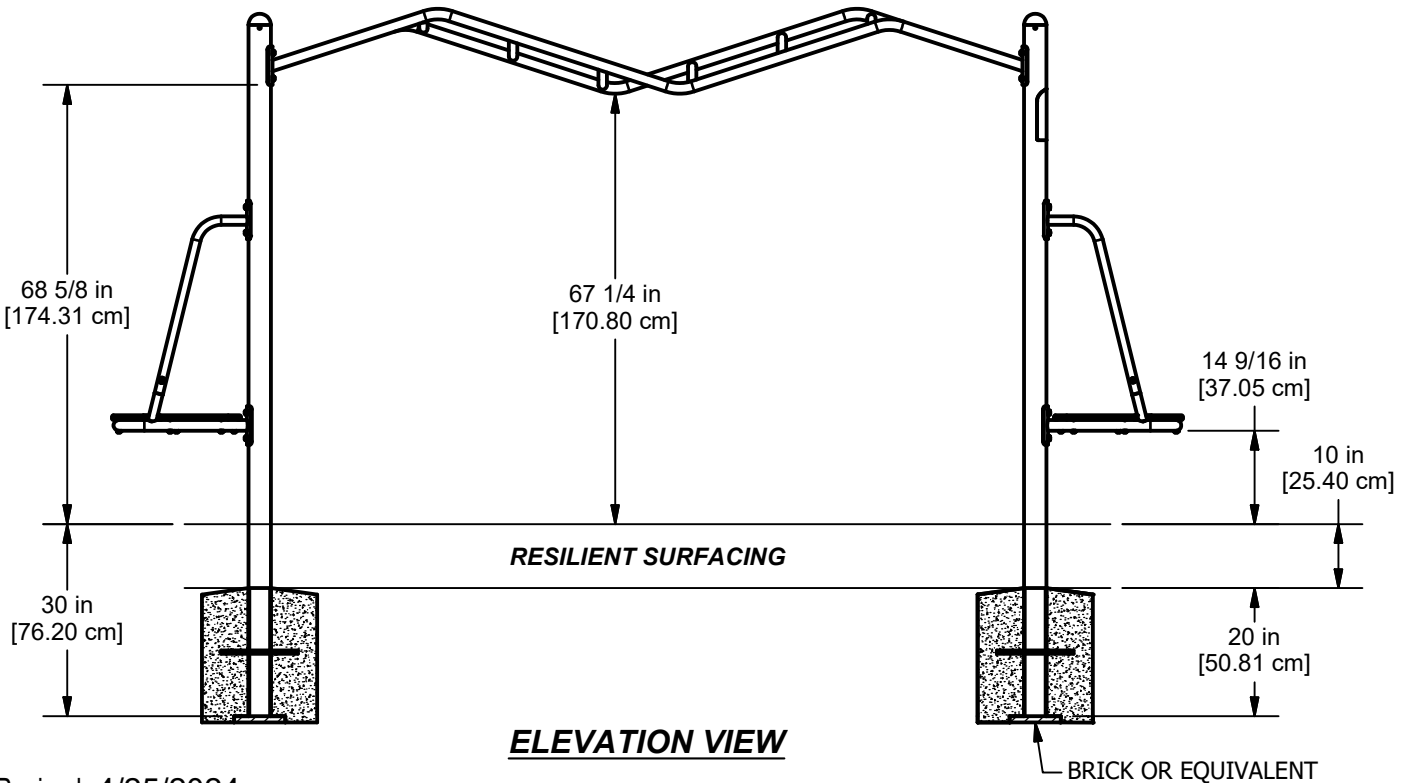

ELEVATION VIEW

Issued/Revised: 4/25/2024

UP267 STRENGTH ZONE USE ZONE

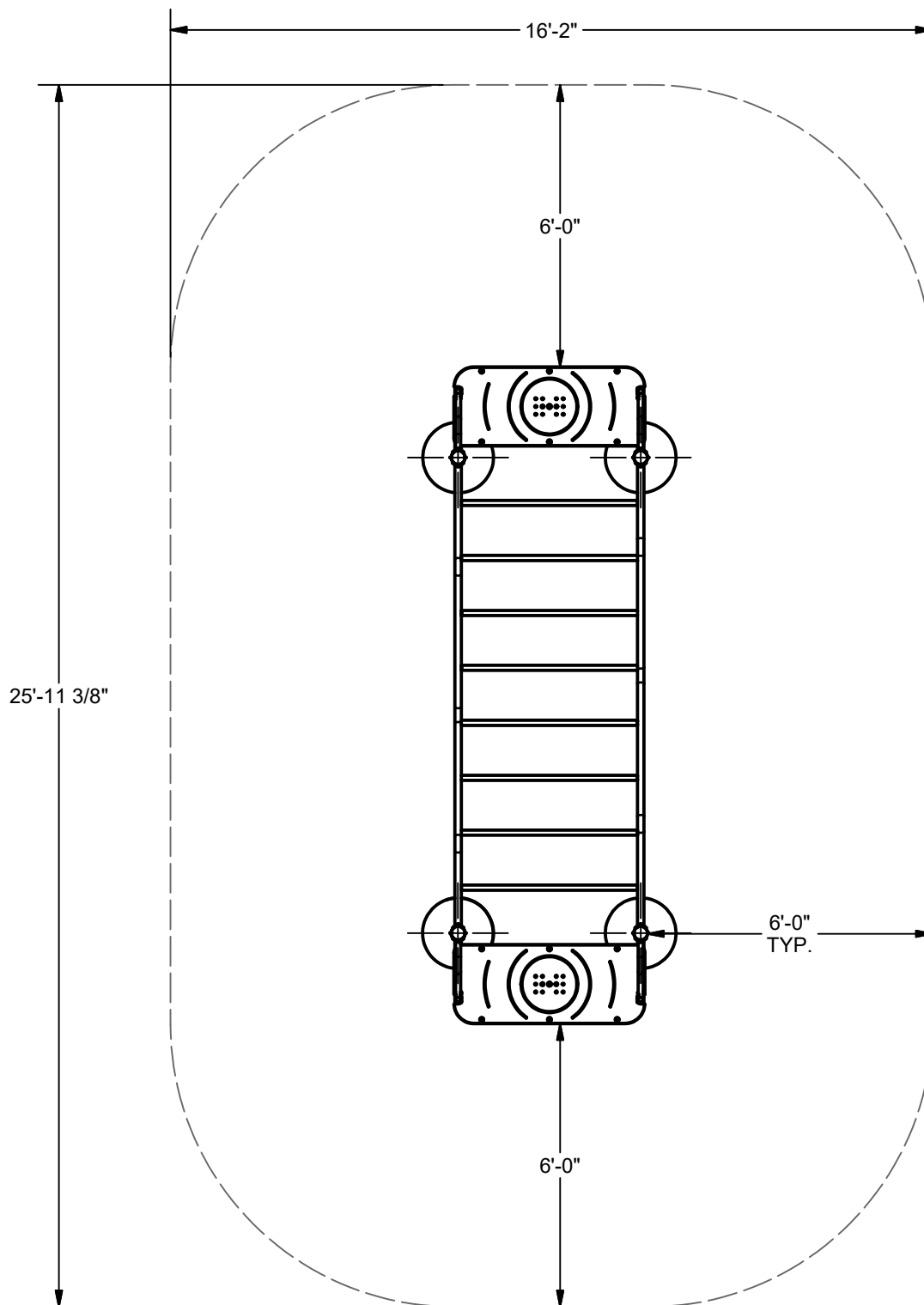

USE ZONE

Issued/Revised: 4/25/2024

800.458.5872

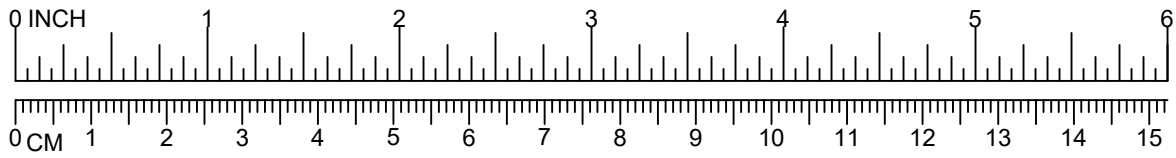

UP267 STRENGTH ZONE

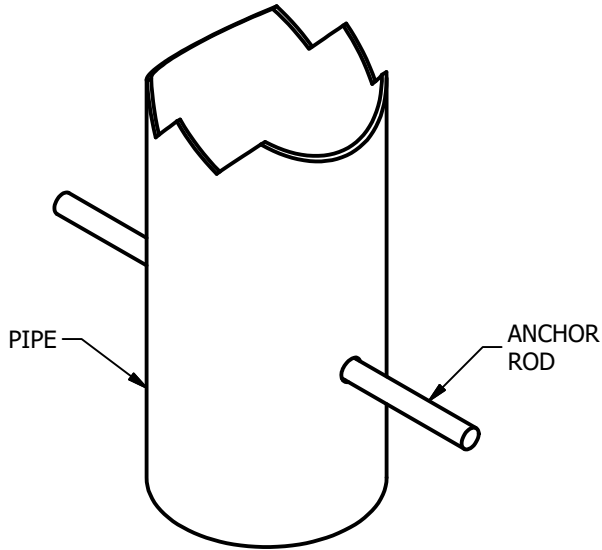

231

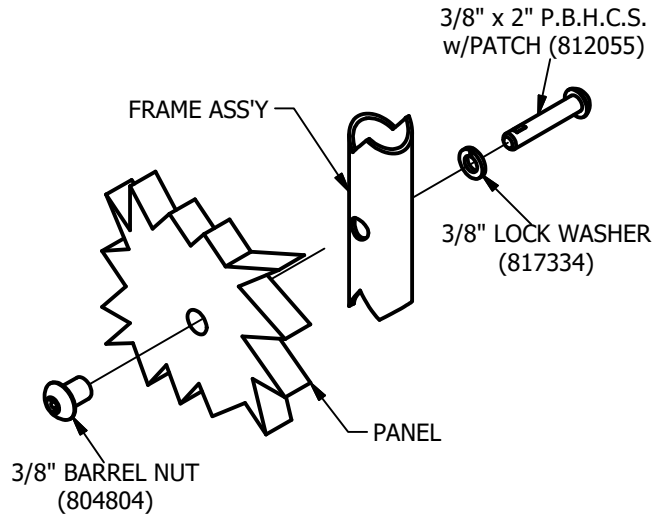

353

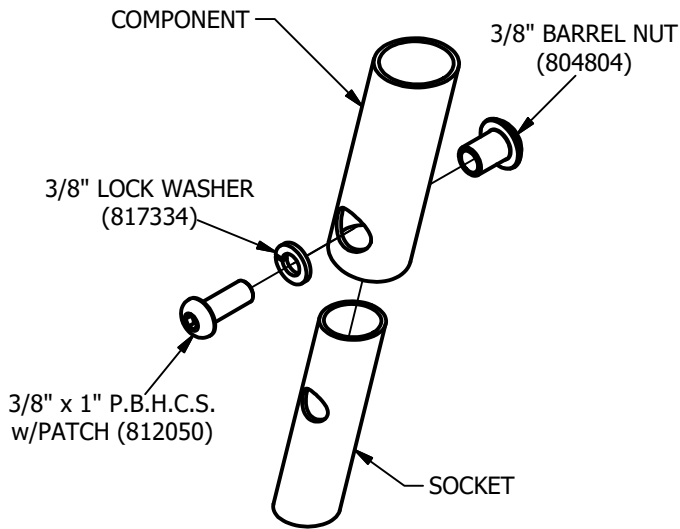

430

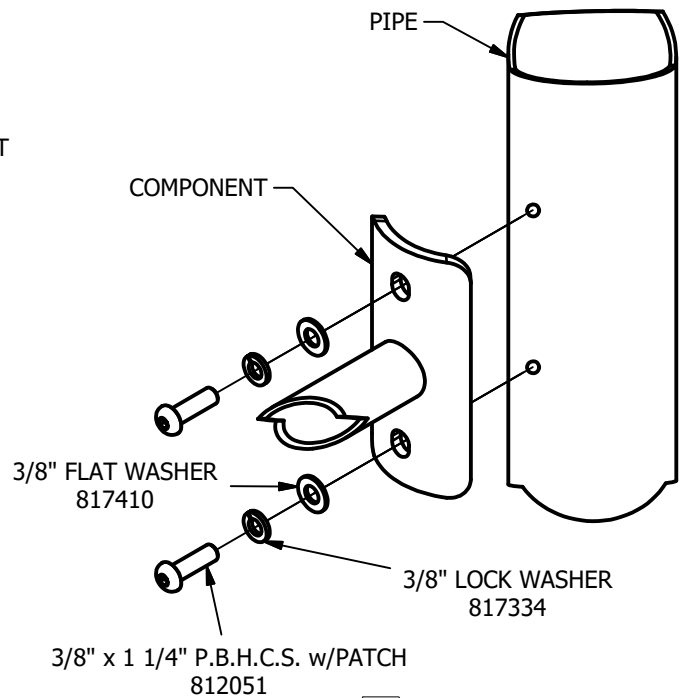

1267